

Every pump tested in water to ensure pump meets performance curve.



FEATURES/BENEFITS

PERFORMANCE

- Heads up to 65' TDH
- Flows up to 86 GPM

MOTOR

- High efficient, 115v or 230v, oil filled, permanent split capacitor motor with upper and lower ball bearings and thermal overload protection
- Constant bearing lubrication
 - Maximum motor cooling
 - Runs cooler and lasts longer
 - Internal overload protection
 - Quiet operation
 - Fasteners and shaft made from rugged, corrosion resistant stainless steel

SEAL DESIGN

- Type 21 inboard seal design with secondary exclusion seal
- Rotating components of seal are in the motor housing, being lubricated by the motor oil preventing foreign matter from wrapping around the seal components
 - Seal will last longer if the pump runs dry
 - Secondary exclusion seal keeps debris from entering the seal cavity

IMPELLER DESIGN

- Non-clog style, cast-iron vortex impeller (CPEH Thermoplastic Vortex)
- Designed to help reduce clogging by foreign material

POWER CORD

- Sealed entry quick disconnect power cords
- Prevents water from entering the motor housing through a cut cord
 - Easy to replace in the field
 - Available in lengths up to 100'

SWITCH

- Piggy-back switch design
- Defective switches can be diagnosed over the phone
 - Pump can be operated manually or supplied with other piggy-back switches
 - Switch can be replaced without having to replace the pump

APPLICATIONS

Dewatering, septic systems, residential and commercial developments, elevator pits and STEP systems



Vertical Float

Wide-Angle Float

4/10-1/2 HP submersible pumps that handle up to 3/4" solids with 2" discharge

PERFORMANCE CURVE

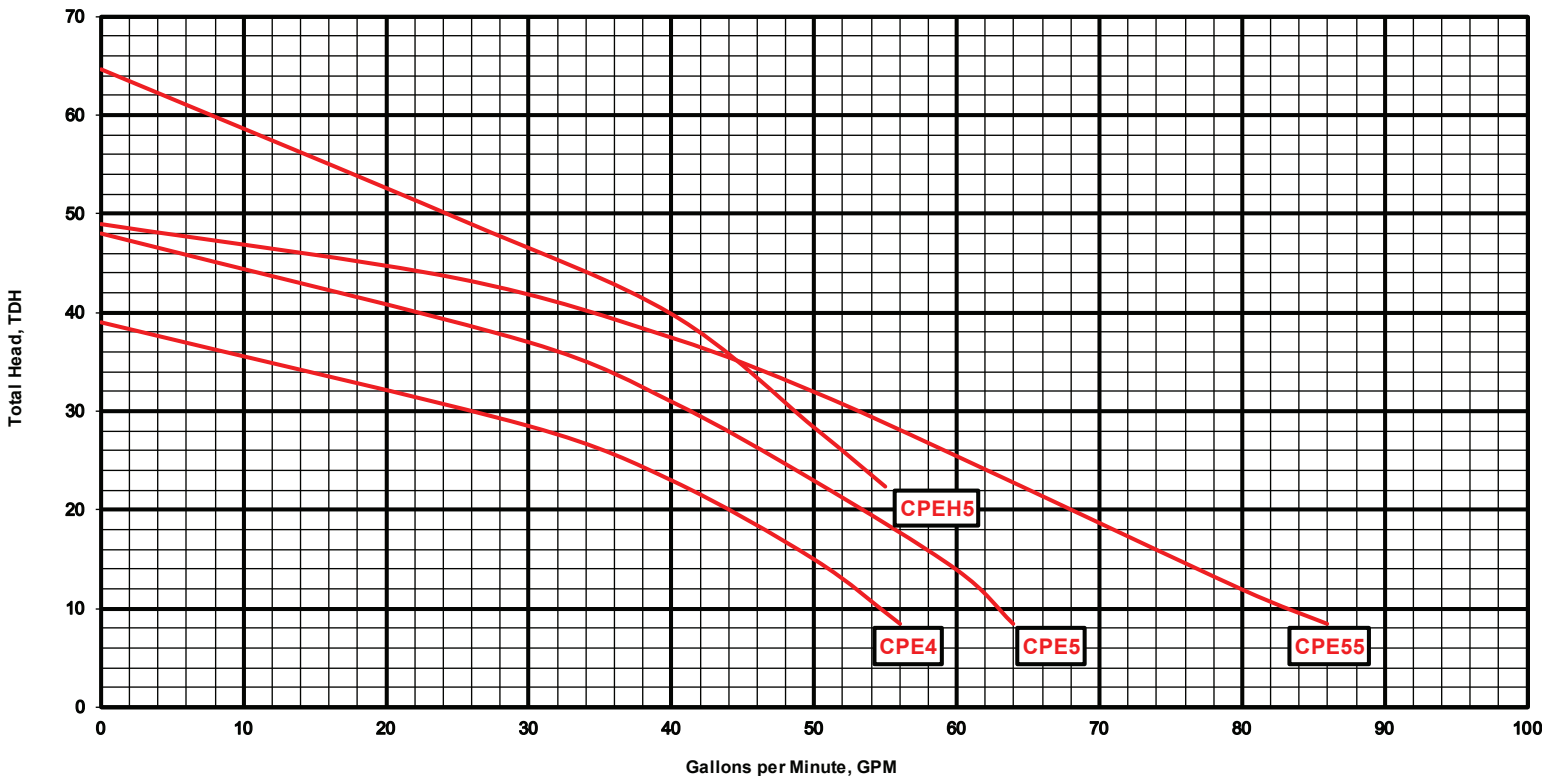

TECHNICAL DATA

DISCHARGE	2" NPT. vertical standard
LIQUID TEMPERATURE	140 Degrees F. (Intermittent)
MOTOR HOUSING	Cast Iron
VOLUTE	Cast Iron
SEAL PLATE	Cast Iron
IMPELLER	Cast Iron / Vortex (CPEH thermoplastic vortex)
SOLIDS HANDLING	3/4"
SHAFT	Stainless Steel
SHAFT SEAL (SINGLE SEAL)	Inboard mechanical with secondary exclusion V-Seal, carbon rotating face, ceramic stationary face, Buna-N elastomer, 300 series stainless steel hardware
BEARINGS (UPPER & LOWER)	Single row, ball, oil lubricated
HARDWARE	300 Series stainless steel
O-RINGS	Buna-N
CORD	20' Length standard. Up to 100' available. (UL/CUL) Listed 16 AWG, Type SJTW
MOTOR (SINGLE PHASE)	4/10-1/2 HP 3450 RPM, 60 Hz, NEMA L Includes Overload Protection in the motor, oil filled, class B permanent split capacitor
WEIGHT	37 lbs. (Manual)

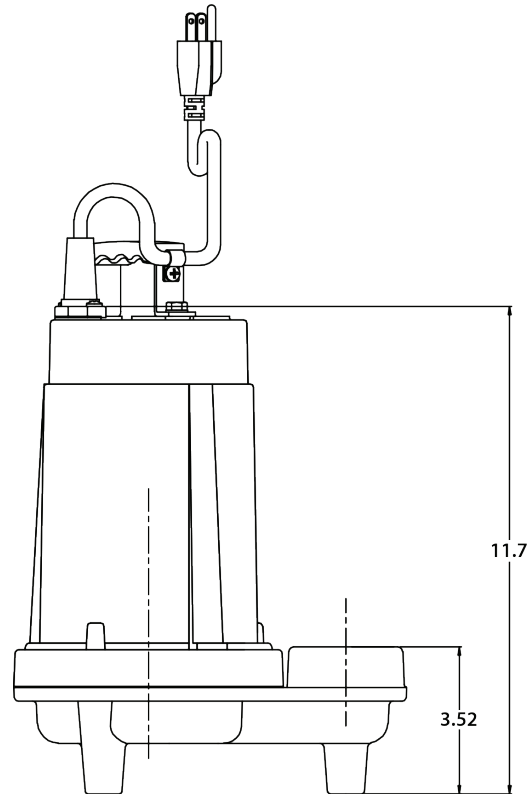
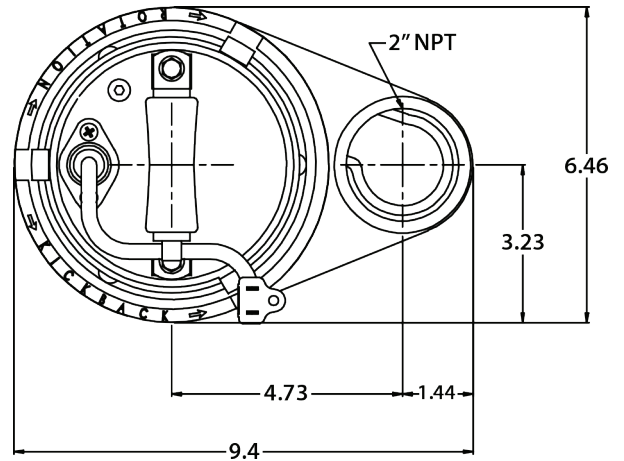

MODEL(S) INFORMATION

MODEL	HP	VOLTS	PHASE	AMPS	CORD LENGTH	SWITCH
CPE4-12 / CPE5-12 / CPE55-12 / CPEH5-12	4/10 - 1/2	115	1	6.6 / 8.5 / 10.5 / 11.5	20'	Manual
CPE4-13 / CPE5-13 / CPE55-13 / CPEH5-13	4/10 - 1/2	115	1	6.6 / 8.5 / 10.5 / 11.5	30'	Manual
CPE4-15 / CPE5-15 / CPE55-15 / CPEH5-15	4/10 - 1/2	115	1	6.6 / 8.5 / 10.5 / 11.5	50'	Manual
CPE4A-12 / CPE5A-12 / CPE55A-12 / CPEH5A-12	4/10 - 1/2	115	1	6.6 / 8.5 / 10.5 / 11.5	20'	Wide-Angle Float
CPE4A-13 / CPE5A-13 / CPE55A-13 / CPEH5A-13	4/10 - 1/2	115	1	6.6 / 8.5 / 10.5 / 11.5	30'	Wide-Angle Float
CPE4V-12 / CPE5V-12 / CPE55V-12 / CPEH5V-12	4/10 - 1/2	115	1	6.6 / 8.5 / 10.5 / 11.5	20'	Vertical Float
CPE4V-13 / CPE5V-13 / CPE55V-13 / CPEH5V-13	4/10 - 1/2	115	1	6.6 / 8.5 / 10.5 / 11.5	30'	Vertical Float
CPE4-22 / CPE5-22 / CPE55-22 / CPEH5-22	4/10 - 1/2	230	1	3.3 / 4.3 / 5.75 / 5.75	20'	Manual
CPE4A-22 / CPE5A-22 / CPE55A-22 / CPEH5A-22	4/10 - 1/2	230	1	3.3 / 4.3 / 5.75 / 5.75	20'	Wide-Angle Float
CPE4V-22 / CPE5V-22 / CPE55V-22 / CPEH5V-22	4/10 - 1/2	230	1	3.3 / 4.3 / 5.75 / 5.75	20'	Vertical Float